

SPECIFICATIONS

Yanama Vanity

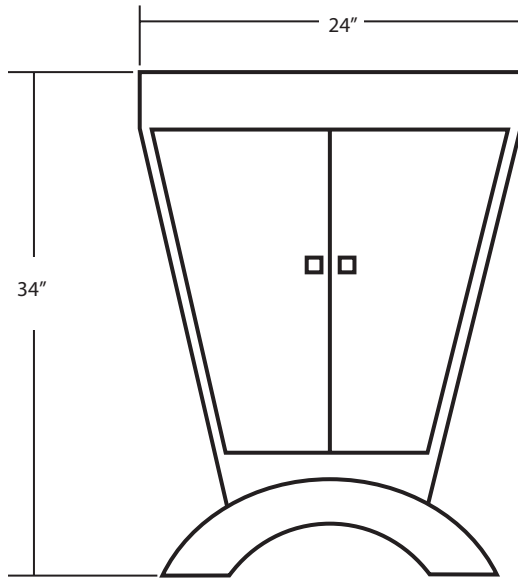

VNF242- Antique
VNF245- Brushed Nickel



PRODUCT DETAILS

- * 24"w x 21.5"d x 34"h
- * FSC* certified Cherry
- * Hand hammered 16 guage recycled copper
- * Handcrafted & hand finished
- * Dimensions are not exact and may vary $\pm 1/2"$

INSTALLATION

- * Freestanding vanity base

COORDINATING PRODUCTS

- * Native Trails stone or Sedona vanity top

IMPORTANT

Due to the handcrafted nature of this product, it will vary in finish, texture, hammering, and other details. Dimensions may vary up to $1/2"$.

*Forest Stewardship Council

